

**External dimensions (mm):** 750x340x300  
**Total weight (kg):** 6,00  
**Capacity (lt):** 60  
**Composition:** 100% polyethylene + steel elements  
**Quantity per pallet (pcs):** 18<sup>(1)</sup>/ 21<sup>(2)</sup>  
**Loaded pallet weight (kg):** 130<sup>(1)</sup>/ 145<sup>(2)</sup>  
**Loaded pallet size (cm):** 120x80x200<sup>(1)</sup>/ 120x80x230<sup>(2)</sup>

<sup>(1)</sup>Smaller trucks / <sup>(2)</sup>Lorry



### Standard equipment

Handle and T-lock with a three-point bolt  
Reinforcement of the locking system on the box  
Steel hinges  
EDPM rubber seal  
Side badges locking the side bolts  
Thicker frame make the body corp more stiff

### Characteristics

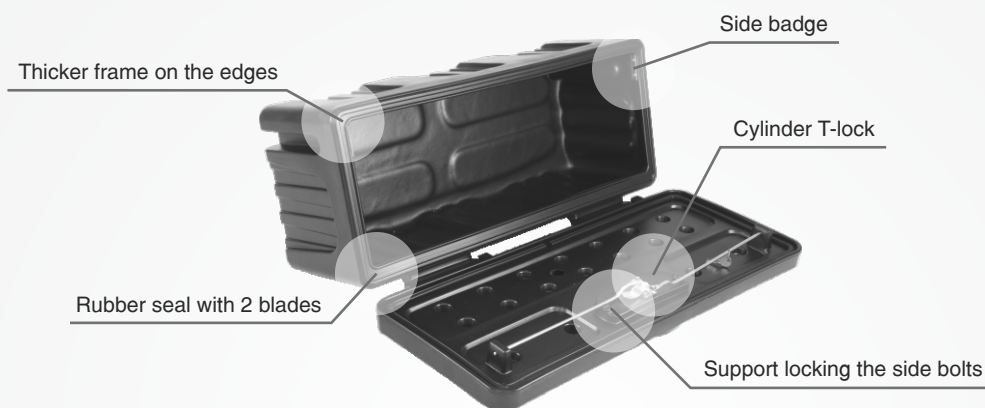

### Technical drawing - toolbox size 750 x 340 x 300

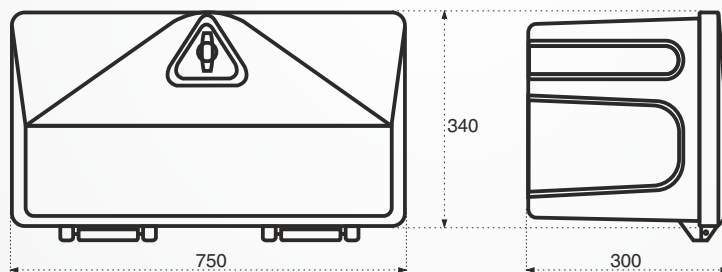

### Mounting kit recommended

Mounting kit R-type: 710003

Mounting kit L-type: 710005



### Spare parts

Handle: Z/03  
Rubber seal: S1911  
Cover to the lock: Z / 01-B

### Quality

Made of best quality materials, **Slick-box** optimal payload depends, among the others from the type of mounting kit used. It is recommended to use the original mounting kit brand Stabilo.